

Getting Started With Dropbox

1. You will receive an email from your coach inviting you to a 'Shared Folder'. This folder will be used to submit your lesson plans and unit plans for our PA STEM Initiative.

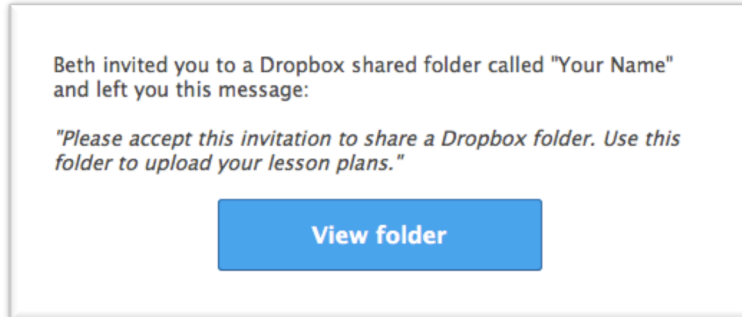

You will receive an email that shows this message when you open it. Click "View Folder"

2. You will then be prompted to sign in to your Dropbox account or to create a new account. Next you will need to click "Accept" the invitation.

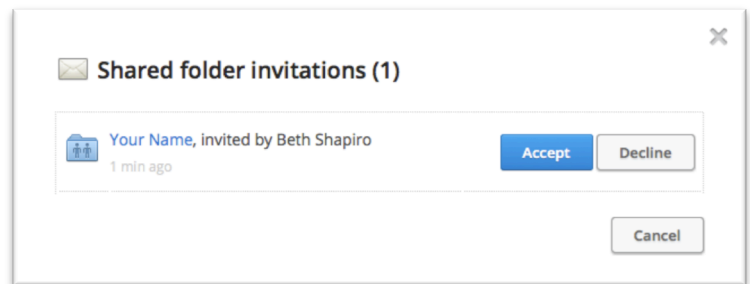
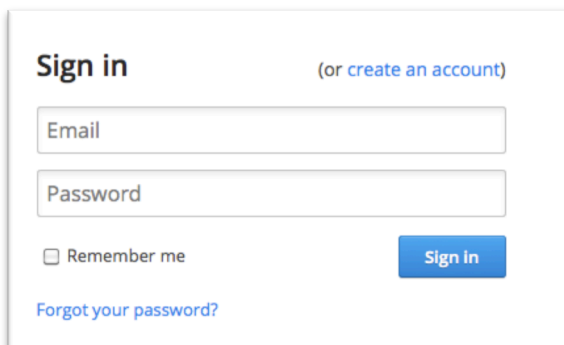

3. To upload your Lesson Plan, click on the 'Upload' icon at the top of your browser window. Alternatively, if you installed Dropbox on your computer, you can put your lesson plan into the shared Dropbox folder on your computer. It is automatically synced to your online Dropbox account and shared with your coach.

